



66 Essella Road

Ashford, TN24 8AW

Price £375,000

Attractive three bedroom bay fronted semi detached house being offered for sale with no chain.

Well presented throughout the property comprises of sitting room, dining room, downstairs cloakroom, modern kitchen with integral appliances, three bedrooms and shower room. There is a impressive side garden which is mainly laid to lawn with wooden summer house. To the rear is a patioed courtyard with door to the garage. The front garden is block paved providing off road parking.

- THREE BEDROOM SEMI DETACHED
- IMPRESSIVE SIDE GARDEN
- MODERN KITCHEN
- INTEGRAL APPLIANCES
- DOWNSTAIRS CLOAKROOM
- OFF ROAD PARKING
- GARAGE
- NO CHAIN

Viewing

Please contact our Ashford Office on 01233 646411 if you wish to arrange a viewing appointment for this property or require further information.



Floor Plan

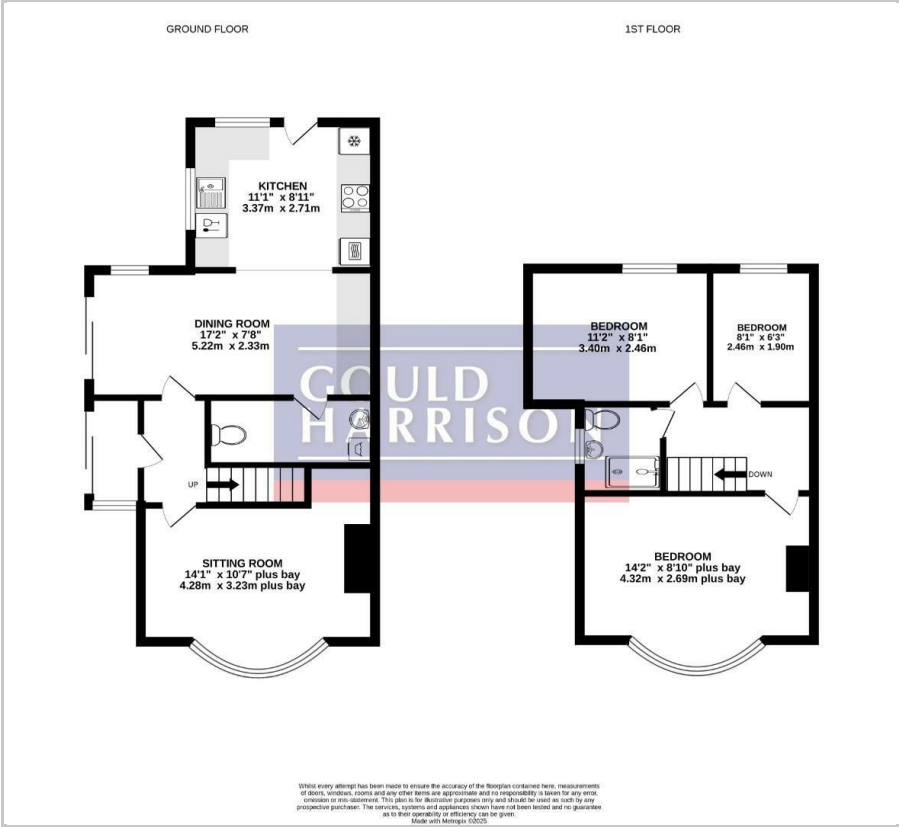

Area Map



Energy Efficiency Graph

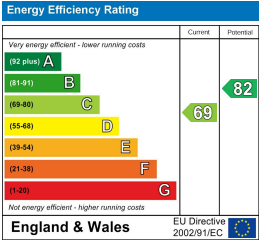

These particulars, whilst believed to be accurate are set out as a general outline only for guidance and do not constitute any part of an offer or contract. Intending purchasers should not rely on them as statements of representation of fact, but must satisfy themselves by inspection or otherwise as to their accuracy. No person in this firms employment has the authority to make or give any representation or warranty in respect of the property.